

# Crossword Puzzle Scavenger Hunt

Can you find the hidden words? Forward, Backward, Diagonal

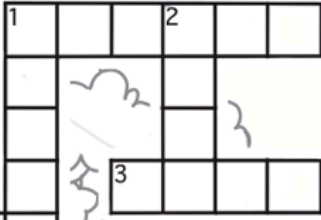

Down

1. Lake \_\_\_\_\_
2. a large body of water surrounded by land.
3. \_\_\_\_\_
4. Camp \_\_\_\_\_

8. movement of the body through the water using arms and legs.

Across

1. Mount \_\_\_\_\_
3. Please don't feed the \_\_\_\_\_.
5. There are many of them in a forest.
6. strip of land covered with sand at the edge of a body of water.
7. landform that rise high above its surroundings.



- CAMP
- LAKE
- MOUNTAIN
- TREE
- BEACH
- KAYAK
- TAHOE
- SWIM
- TALLAC
- WAVE
- BEAR

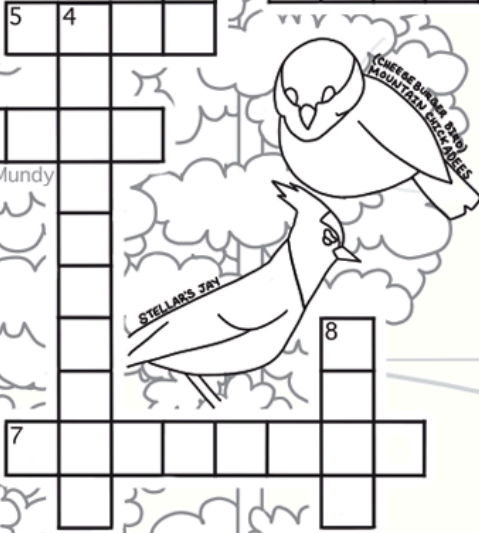

Diamond Mundy

STELLAR JAY

BALD EAGLE

Can you find 5 pinecones?

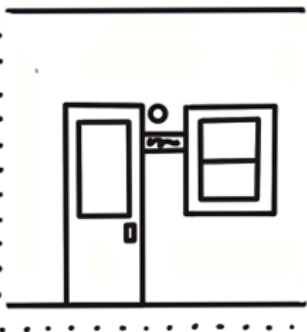

Follow the dotted lines to build your cabin!

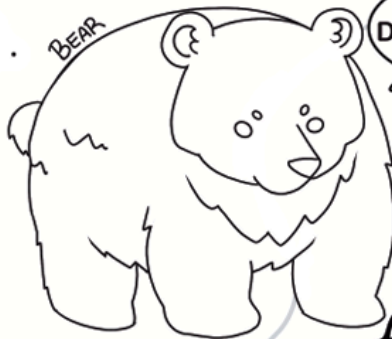

DONT FEED ME!

STAY AWAY FROM BEARS!



GERMAN BROWNS

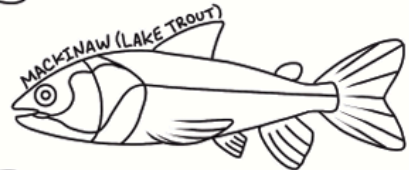

MACKINAW (LAKE TROUT)



RAINBOW TROUT

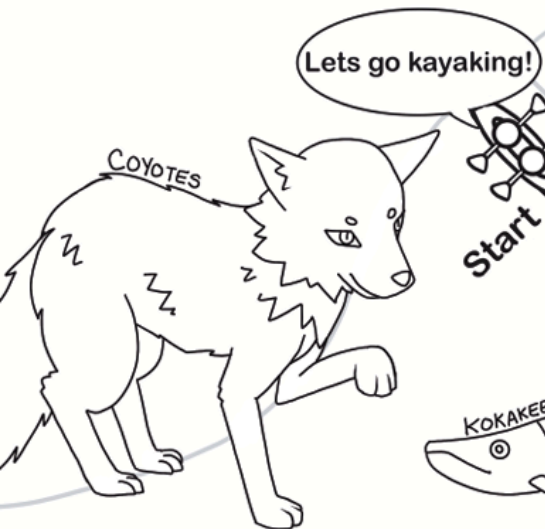

Lets go kayaking!

COYOTES



KOKAKEE SALMON



Start

Finish



# The Grove Kids Menu

**All Kids Meals are 12.99**

## **CHEESEBURGER\***

Served with Seasoned Fries or Fresh Fruit

## **CHICKEN FINGERS**

Served with Seasoned Fries or Fresh Fruit

## **GRILLED CHEESE**

Served with Seasoned Fries or Fresh Fruit

## **MAC & CHEESE**

\*Consuming raw or undercooked meats, poultry, seafood, shellfish, or eggs may increase your risk of foodborne illness, especially if you have certain medical conditions please be advised that our kitchen handles all major food allergens, including milk, eggs, fish, shellfish, tree nuts, peanuts, wheat, and soy. Please inform our staff of any food allergies. There will be an automatic 20% service charge added for all parties of 6 or more.

